



PARTS LIST FOR MODEL 9500SS

PART# 69-9500

MANUAL BAIL KIT

REPLACES: PART# 24-9500
PART# 34-9500

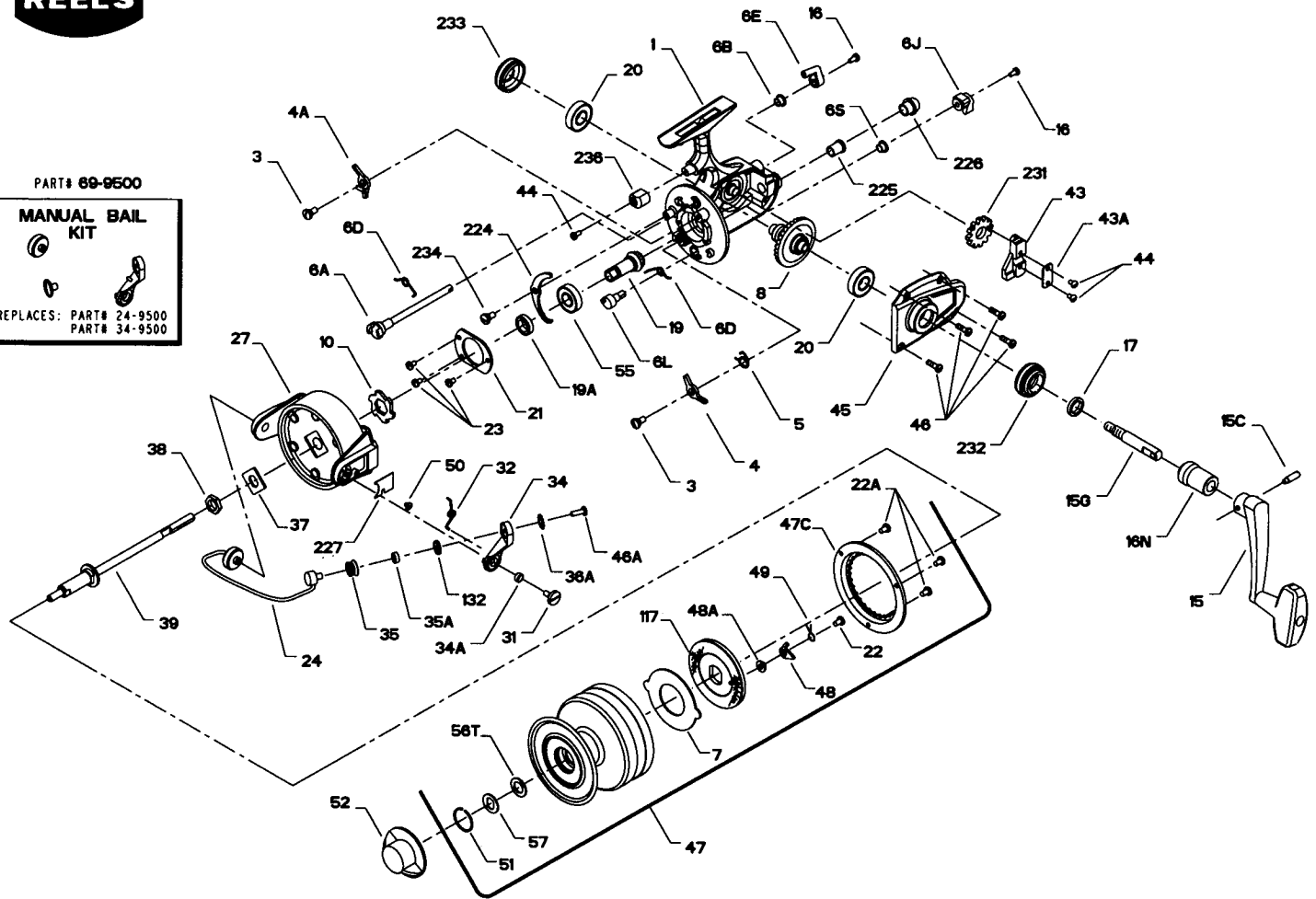

KEY NO.

DESCRIPTION

1	Housing
3	Dog Screw (2 req.)
4	Dog
4A	Silent Dog
5	Click Dog Spring
6A	Upper Eccentric
6B	Upper Eccentric Liner
6D	Eccentric Spring
6E	Anti-Reverse Lever
6J	Silent Dog Lever
6L	Silent Eccentric
6S	Silent Eccentric Liner
7	Metal Drag Washer
8	Main Gear
10	Ratchet
15	Handle
15C	Handle Pivot Screw
15G	Handle Pivot
16	Eccentric Screw (2 req.)
16N	Collar
17	Seal Washer
19	Pinion
19A	Pinion Spacer
20	Ball Bearing (2 req.)
21	Bearing Cover
22	Spool Click Screw
22A	Drag Cover Screw (3 req.)
23	Bearing Cover Screw (3 req.)
24	Bail Wire
27	Rotor
31	Bail Arm Screw
32	Bail Arm Spring
34	Bail Arm
34A	Bail Arm Bushing
35	Line Roller
35A	Line Roller Bearing
36A	Lock Washer
37	Rotor Washer
38	Rotor Nut
39	Spool Shaft
43	Spool Block
43A	Crosswind Block Plate
44	Crosswind Block Screw (3 req.)
45	Housing Cover
46	Housing Cover Screw (4 req.)
46A	Bail Stud Screw
47	Spool (Complete)
47C	Drag Cover
48	Click Tongue
48A	Click Tongue Washer
49	Click Tongue Spring
50	Bail Spring Cover Screw
51	Retaining Ring
52	Drag Knob
55	Ball Bearing
56T	Drag Washer (Teflon®)
57	Drag Washer Keyed
69	Manual Bail Kit (Optional)
117	Drag Washer/Drive Plate
132	Roller Washer
224	Transfer Lever
225	Crosswind Shaft Bushing
226	Bushing Cap Screw
227	Bail Spring Cover
231	Crosswind Gear
232	Bearing Cover (Open)
233	Bearing Cover (Closed)
234	Transfer Lever Screw
236	Trip Bumper

KEY NO.

DESCRIPTION

35	Line Roller
35A	Line Roller Bearing
36A	Lock Washer
37	Rotor Washer
38	Rotor Nut
39	Spool Shaft
43	Spool Block
43A	Crosswind Block Plate
44	Crosswind Block Screw (3 req.)
45	Housing Cover
46	Housing Cover Screw (4 req.)
46A	Bail Stud Screw
47	Spool (Complete)
47C	Drag Cover
48	Click Tongue
48A	Click Tongue Washer
49	Click Tongue Spring
50	Bail Spring Cover Screw
51	Retaining Ring
52	Drag Knob
55	Ball Bearing
56T	Drag Washer (Teflon®)
57	Drag Washer Keyed
69	Manual Bail Kit (Optional)
117	Drag Washer/Drive Plate
132	Roller Washer
224	Transfer Lever
225	Crosswind Shaft Bushing
226	Bushing Cap Screw
227	Bail Spring Cover
231	Crosswind Gear
232	Bearing Cover (Open)
233	Bearing Cover (Closed)
234	Transfer Lever Screw
236	Trip Bumper
35-9500	Line Roller
35A-706	Line Roller Bearing
36A-750	Lock Washer
37-9500	Rotor Washer
38-9500	Rotor Nut
39-9500	Spool Shaft
43-9500	Spool Block
43A-750	Crosswind Block Plate
44-750	Crosswind Block Screw (3 req.)
45-9500	Housing Cover
46-9500	Housing Cover Screw (4 req.)
46A-9500	Bail Stud Screw
47-9500	Spool (Complete)
47C-9500	Drag Cover
48-9500	Click Tongue
48A-9500	Click Tongue Washer
49-9500	Click Tongue Spring
50-712	Bail Spring Cover Screw
51-704	Retaining Ring
52-650	Drag Knob
55-50	Ball Bearing
56T-704	Drag Washer (Teflon®)
57-704	Drag Washer Keyed
69-9500	Manual Bail Kit (Optional)
117-9500	Drag Washer/Drive Plate
132-706	Roller Washer
224-750	Transfer Lever
225-9500	Crosswind Shaft Bushing
226-9500	Bushing Cap Screw
227-9500	Bail Spring Cover
231-9500	Crosswind Gear
232-750	Bearing Cover (Open)
233-750	Bearing Cover (Closed)
234-750	Transfer Lever Screw
236-750	Trip Bumper