

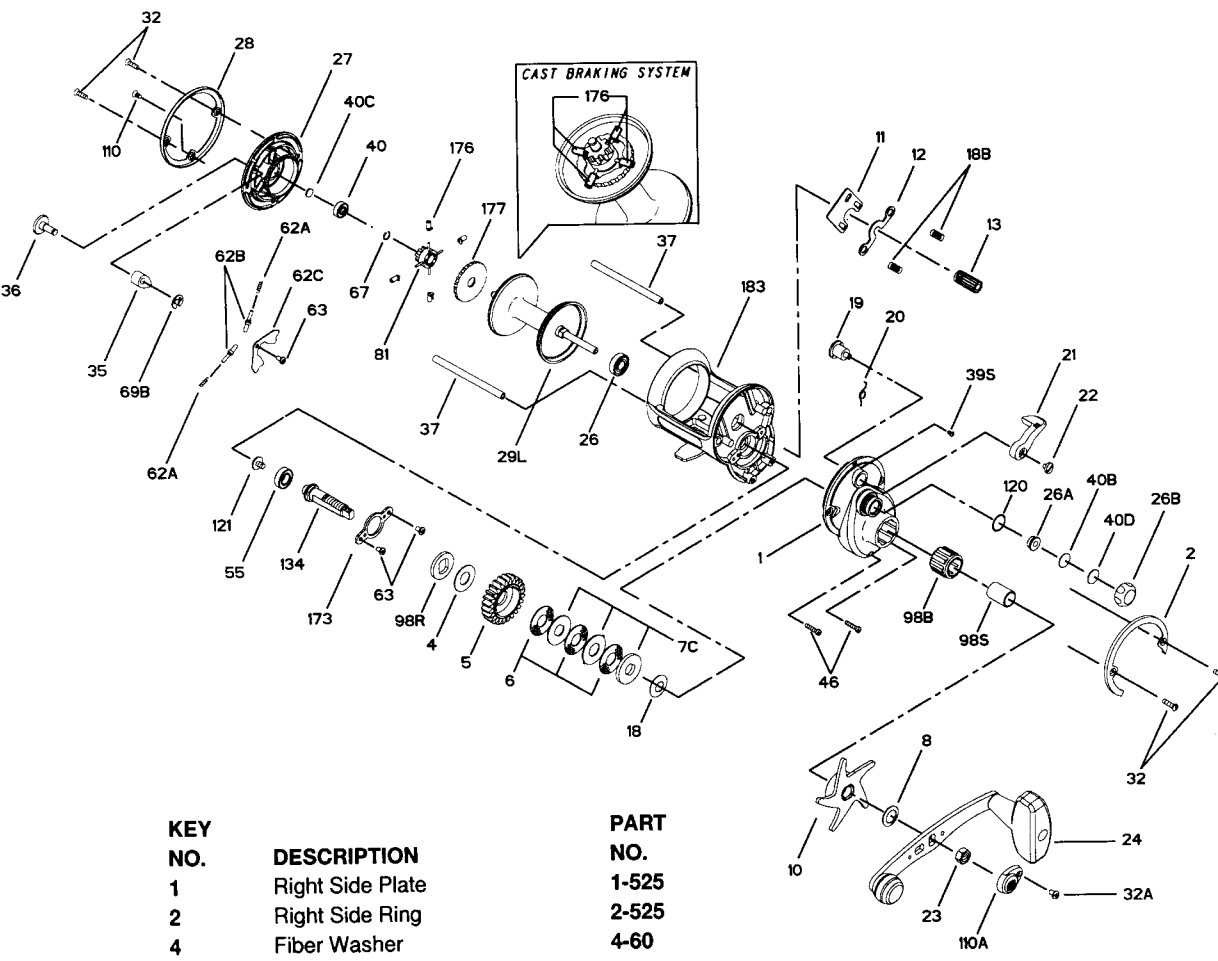

PARTS LIST FOR MODEL 525GS



KEY NO.	DESCRIPTION	PART NO.
1	Right Side Plate	1-525
2	Right Side Ring	2-525
4	Fiber Washer	4-60
5	Main Gear	5-545
6	Friction Drag Washer (3 req.)	6-49
7C	Metal Drag Washer (Set)	7C-49
8	Tension Spring Washer	8-60
10	Drag Star	10-525
11	Eccentric Jack	11-525
12	Pinion Yoke	12-555
13	Pinion Gear	13-545
18	Tension Spring Washer	18-505
18B	Clutch Spring (2 req.)	18-525
19	Eccentric	19-525

KEY NO.	DESCRIPTION	PART NO.
20	Eccentric Spring	20-155
21	Eccentric Lever	21-525
22	Eccentric Screw	22-310
23	Handle Nut	23-555
24	Handle	24-555
26	R.S. Spool Ball Bearing	26-25
26A	Right Side Bushing	26-555
26B	Spool Tension Control Cap	26B-555
27	Left Side Plate	27-525
28	Left Side Ring	28-525
29L	Aluminum Spool Assembly	29L-525
32	Frame Post Screw (4 req.)	32-310
32A	Handle Lock Screw	32-15
35	Click Tongue	35-525
36	Click Button	36-525
37	Frame Post (2 req.)	37-525
39S	Right Side Plate Screw	39S-965
40	L.S. Spool Ball Bearing	40-320
40B	Metal Thrust Washer	40C-555
40C	Metal Thrust Washer	40C-310
40D	Rubber Thrust Washer	40D-555
46	Side Plate Screw (2 req.)	46-4300
55	Ball Bearing	20-722
62A	Click Spring (2 req.)	62-545
62B	Click Pin (2 req.)	62B-525
62C	Click Spring Cover	62C-525
63	Retainer Screw (3 req.)	63-500S
67	Lock Ring	67-9
69B	Retaining Ring	69B-600
81	Click Ratchet	81-525
98B	Anti-Reverse Bearing	98B-525
98R	Ratchet Spacer	98-525
98S	Clutch Shaft	98S-525
110	Side Plate Short Screw	110-50
110A	Handle Nut Lock Cap	110A-555
120	O-Ring	120-113H
121	Bearing Screw	121-555
134	Gear Stud	134-525
173	Bearing Retainer	173-525
176	Casting Brakes (4 req.)	176-965
177	Brake Selection Knob	177-965
183	Frame	183-525